

BJ

Low Flow

DESIGN FEATURES

- Three-piece construction
- Interchangeable spray tips
- Integral strainer available (refer to page 115 for more information)
- Male and female connections

SPRAY CHARACTERISTICS

- Relatively coarse atomization
- Uniform distribution with tapered edges for use in overlapping sprays

Spray pattern: Flat Fan

Spray angles: 0° to 110°

Flow rate: 0.024 to 24.7 gpm



Metal



FAN

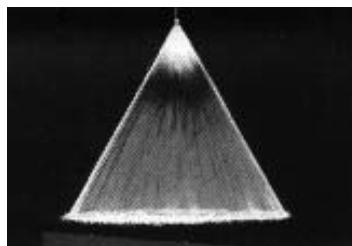

Fan 50°

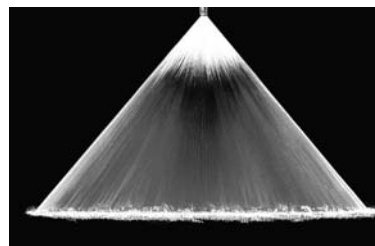

Fan 80°

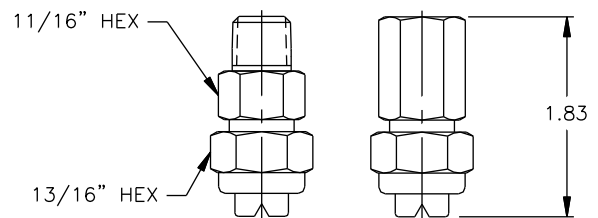

Dimensions are approximate. Check with BETE for critical dimension applications.

BJ Spray Angles and Weights

Fan, 0° to 110° Spray Angles, 1/8", 1/4" and 3/8" Pipe Size, Male and Female

Pipe Size	Nozzle Number	Flow Rate @ 40 psi	Available Spray Angle										Optional Strainer Mesh Size	Wt. (Oz.)	
			0°	15°	25°	40°	50°	65°	73°	80°	95°	110°			
1/8"	BJ 0067	0.067	0°	15°	25°	40°	50°	65°						100	2
	BJ 0077	0.077							73°						
	BJ 01	0.10	0°	15°	25°	40°	50°	65°		80°	95°	110°			
	BJ 0116	0.12							73°						
OR	BJ 015	0.15	0°	15°	25°	40°	50°	65°		80°	95°	110°	50	2	
	BJ 0154	0.15							73°						
	BJ 02	0.20	0°	15°	25°	40°	50°	65°		80°	95°	110°			
	BJ 0231	0.23							73°						
1/4"	BJ 03	0.30	0°	15°	25°	40°	50°	65°		80°	95°	110°	50	2	
	BJ 0308	0.31							73°						
	BJ 0385	0.39	0°	15°	25°	40°	50°	65°		80°	95°	110°			
	BJ 04	0.40	0°	15°	25°	40°	50°	65°		80°	95°	110°			
OR	BJ 0462	0.46							73°						
	BJ 05	0.50	0°	15°	25°	40°	50°	65°		80°	95°	110°	50	2	
	BJ 06	0.60	0°	15°	25°	40°	50°	65°		80°	95°	110°			
	BJ 0616	0.62							73°						
BJ 077	0.77							73°							
3/8"	BJ 08	0.80	0°	15°	25°	40°	50°	65°		80°	95°	110°	50	2	
	BJ 0924	0.92							73°						
	BJ 10	1.0	0°	15°	25°	40°	50°	65°		80°	95°	110°			
	BJ 15	1.5	0°	15°	25°	40°	50°	65°		80°	95°	110°			
1/2"	BJ 20	2.0	0°	15°	25°	40°	50°	65°		80°	95°	110°	50	2	
	BJ 30	3.0	0°	15°	25°	40°	50°	65°		80°	95°	110°			
	BJ 40	4.0	0°	15°	25°	40°	50°	65°		80°	95°	110°			
	BJ 50	5.0							80°	95°	110°				
OR	BJ 60	6.0							80°	95°	110°				
	BJ 70	7.0	15°	25°	40°	50°	65°		80°	95°	110°				

Spray angle performance varies with pressure. Contact BETE for specific data on critical applications.

TO ORDER: specify pipe size, connection type, nozzle number, spray angle, and material.

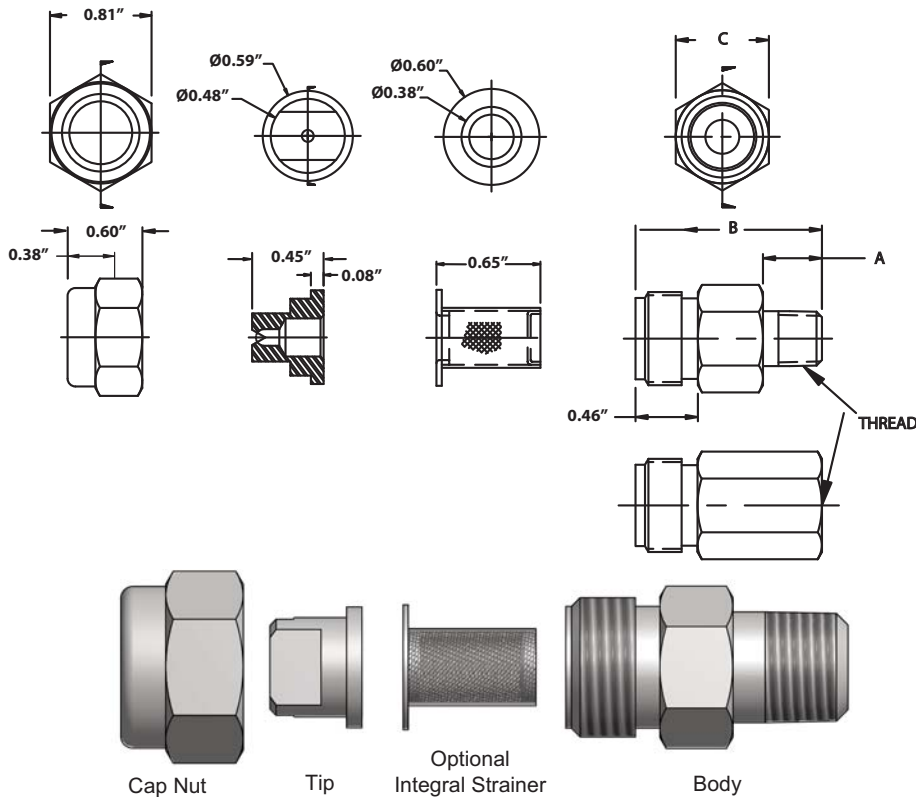

THREAD	A	B	C
1/8" MALE	0.44"	1.38"	11/16"
1/8" FEM	N/A	1.38"	11/16"
1/4" MALE	0.56"	1.38"	11/16"
1/4" FEM	N/A	1.38"	11/16"
3/8" MALE	0.56"	1.38"	11/16"
3/8" FEM	N/A	1.38"	13/16"
1/2" MALE	0.62"	1.38"	7/8"
1/2" FEM	N/A	1.38"	1 1/8"

Dimensions are approximate. Check with BETE for critical dimension applications.



CALL 413-772-0846
Call for the name of your nearest BETE representative.

BJ Flow Rates

Fan, 0°, 15°, 25°, 40°, 50°, 65°, 73°, 80°, 95°, 110° Spray Angles, 1/8", 1/4" and 3/8" Pipe Size, Male and Female

Pipe Size	Nozzle Number	Equiv. Orifice Dia. (in.)	K Factor	GALLONS PER MINUTE @ PSI									
				5 PSI	10 PSI	20 PSI	40 PSI	60 PSI	80 PSI	100 PSI	200 PSI	300 PSI	500 PSI
1/8	BJ 0067	0.023	0.0106	0.024	0.034	0.047	0.067	0.082	0.095	0.11	0.15	0.18	0.24
	BJ 0077	0.023	0.0122	0.027	0.039	0.054	0.077	0.094	0.11	0.12	0.17	0.21	0.27
	BJ 01	0.028	0.0158	0.035	0.050	0.071	0.10	0.12	0.14	0.16	0.22	0.27	0.35
	BJ 0116	0.028	0.0183	0.041	0.058	0.082	0.12	0.14	0.16	0.18	0.26	0.32	0.41
OR	BJ 015	0.033	0.0237	0.053	0.075	0.11	0.15	0.18	0.21	0.24	0.34	0.41	0.53
	BJ 0154	0.033	0.0243	0.054	0.077	0.11	0.15	0.19	0.22	0.24	0.34	0.42	0.54
1/4	BJ 02	0.039	0.0316	0.071	0.10	0.14	0.20	0.24	0.28	0.32	0.45	0.55	0.71
	BJ 0231	0.040	0.0365	0.082	0.12	0.16	0.23	0.28	0.33	0.37	0.52	0.63	0.82
	BJ 03	0.047	0.0474	0.11	0.15	0.21	0.30	0.37	0.42	0.47	0.67	0.82	1.1
OR	BJ 0308	0.047	0.0487	0.11	0.15	0.22	0.31	0.38	0.44	0.49	0.69	0.84	1.1
	BJ 0385	0.051	0.0609	0.14	0.19	0.27	0.39	0.47	0.54	0.61	0.86	1.1	1.4
3/8	BJ 04	0.055	0.0632	0.14	0.20	0.28	0.40	0.49	0.57	0.63	0.89	1.1	1.4
	BJ 0462	0.056	0.0730	0.16	0.23	0.33	0.46	0.57	0.65	0.73	1.0	1.3	1.6
	BJ 05	0.061	0.0791	0.18	0.25	0.35	0.50	0.61	0.71	0.79	1.1	1.4	1.8
	BJ 06	0.067	0.0949	0.21	0.30	0.42	0.60	0.73	0.85	0.95	1.3	1.6	2.1
OR	BJ 0616	0.067	0.0974	0.22	0.31	0.44	0.62	0.75	0.87	0.97	1.4	1.7	2.2
	BJ 077	0.072	0.122	0.27	0.39	0.54	0.77	0.94	1.09	1.2	1.7	2.1	2.7
	BJ 08	0.074	0.127	0.28	0.40	0.57	0.80	0.98	1.1	1.3	1.8	2.2	2.8
	BJ 0924	0.076	0.148	0.33	0.46	0.65	0.92	1.1	1.3	1.5	2.1	2.5	3.3
1/2"	BJ 10	0.086	0.158	0.35	0.5	0.71	1.0	1.2	1.4	1.6	2.2	2.7	3.5
	BJ 15	0.107	0.237	0.53	0.75	1.1	1.5	1.8	2.1	2.4	3.4	4.1	5.3
	BJ 20	0.125	0.316	0.71	1.0	1.4	2.0	2.4	2.8	3.2	4.5	5.5	7.1
3/8	BJ 30	0.141	0.474	1.1	1.5	2.1	3.0	3.7	4.2	4.7	6.7	8.2	10.6
	BJ 40	0.156	0.633	1.4	2.0	2.8	4.0	4.9	5.7	6.3	8.9	11.0	14.1
OR	BJ 50	0.172	0.791	1.8	2.5	3.5	5.0	6.1	7.1	7.9	11.2	13.7	17.7
	BJ 60	0.188	0.949	2.1	3.0	4.2	6.0	7.3	8.5	9.5	13.4	16.4	21.2
1/2"	BJ 70	0.203	1.107	2.5	3.5	4.9	7.0	8.6	9.9	11.1	15.7	19.2	24.7

$$\text{Flow Rate (GPM)} = K \sqrt{\text{PSI}}$$

Standard Materials: Brass, 303 Stainless Steel, and 316 Stainless Steel (for nozzle number BJ01 and higher).

Spray angle performance varies with pressure. Contact BETE for specific data on critical applications.