

CW

Low Flow

DESIGN FEATURES

- Standard 3-piece construction
- Optional 50- or 100-mesh strainer (refer to page 108 for additional information)
- Protective cover available
- Male and female connections
- Interchangeable spray tips

SPRAY CHARACTERISTICS

- Spray patterns:** Full (F) or Hollow Cone (H)
Spray angles: 80° and 120°
Flow rates: 0.424 to 8.39 l/min

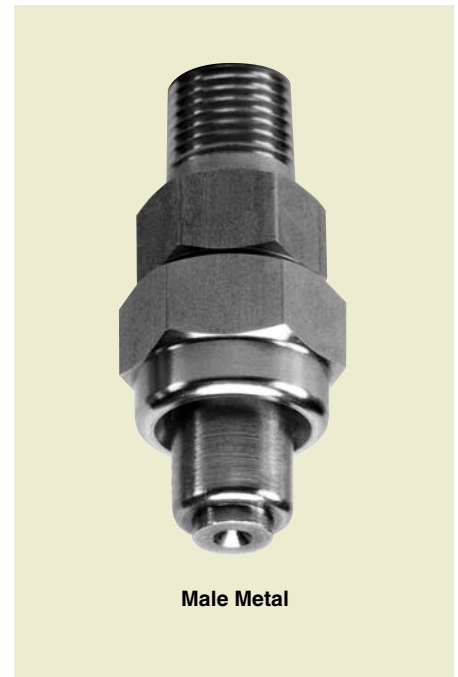

Male Metal



WHIRL

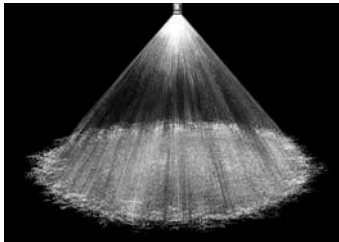

Full Cone 80° (F)

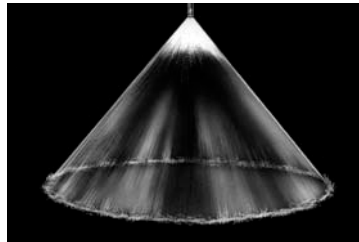

Hollow Cone 80° (H)

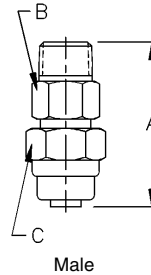

Male

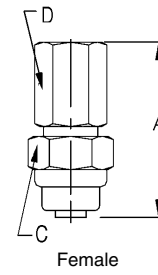

Female

Dimensions are approximate. Check with BETE for critical dimension applications.

CW Flow Rates and Dimensions

Full and Hollow Cone, 80° and 120° Spray Angles, 1/8" to 3/8" Pipe Sizes, BSP or NPT

| Male or Female Pipe Size | Nozzle Number | K Factor | LITERS PER MINUTE @ BAR | | | | | | | | Approx. Orifice Dia.(mm) | Male or Female Pipe Size | Dimensions (mm) | | | | Wt. (g) Metal |
|--------------------------|---------------|----------|-------------------------|---------|-------|-------|-------|-------|--------|--------|--------------------------|--------------------------|-----------------|------|------|------|---------------|
| | | | 0.5 bar | 0.7 bar | 1 bar | 2 bar | 3 bar | 5 bar | 10 bar | 15 bar | | | A | B | C | D | |
| 1/8 or 1/4 or 3/8 | CW25 | 0.587 | 0.424 | 0.497 | 0.587 | 0.814 | 0.984 | 1.25 | 1.73 | 2.10 | 1.14 | 1/8-1/4 | 52.3 | 17.5 | 20.6 | 17.3 | 71 |
| | CW50 | 1.17 | 0.848 | 0.993 | 1.17 | 1.63 | 1.97 | 2.50 | 3.47 | 4.19 | 1.37 | | | | | | |
| | CW75 | 1.76 | 1.27 | 1.49 | 1.76 | 2.44 | 2.95 | 3.75 | 5.20 | 6.29 | 1.60 | 3/8 | 52.3 | 17.5 | 20.6 | 20.6 | |
| | CW100 | 2.35 | 1.70 | 1.99 | 2.35 | 3.25 | 3.94 | 5.01 | 6.93 | 8.39 | 2.18 | | | | | | |

$$\text{Flow Rate (l/min)} = K (\text{bar})^{0.47}$$

Standard Materials: Brass, 303 Stainless Steel and 316 Stainless Steel.

Spray angle performance varies with pressure. Contact BETE for specific data on critical applications.

CALL 413-772-0846
 Call for the name of your nearest BETE representative.