

# LP

## Low Profile

### DESIGN FEATURES

- Provides effective cleaning with low water consumption
- Interchangeable family of shower nozzles
- Self-aligning
- Orifice designed for efficient cleaning

### SPRAY CHARACTERISTICS

**Spray patterns:** Straight Jet and Flat Fan.  
**Spray Angles:** 0°, 30° and 60°  
**Flow rates:** 0.041 to 43.9 gpm



0° Fan

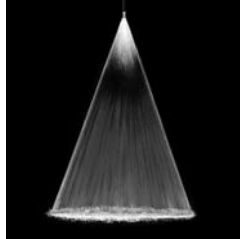

30° Fan

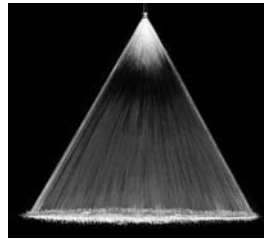

60° Fan



Retaining ring

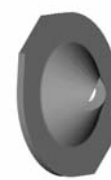

LP nozzle



Gasket

Dimensions are approximate. Check with BETE for critical dimension applications.

### LP Flow Rates and Dimensions

Fan and Straight Jet, 0°, 30° and 60° Spray Angles

| Nozzle Number | Available Spray Angle |     |     | K Factor | GALLONS PER MINUTE @ PSI |        |         |         |         | Equivalent Orifice Dia. (in) |
|---------------|-----------------------|-----|-----|----------|--------------------------|--------|---------|---------|---------|------------------------------|
|               | 0°                    | 30° | 60° |          | 40 PSI                   | 60 PSI | 100 PSI | 250 PSI | 500 PSI |                              |
| LP0041        | 0°                    |     |     | 0.0065   | 0.041                    | 0.050  | 0.065   | 0.103   | 0.14    | 0.016                        |
| LP0073        | 0°                    |     |     | 0.0116   | 0.073                    | 0.089  | 0.12    | 0.18    | 0.26    | 0.024                        |
| LP0090        | 0°                    |     |     | 0.0142   | 0.090                    | 0.11   | 0.14    | 0.23    | 0.32    | 0.028                        |
| LP013         | 0°                    |     |     | 0.0207   | 0.13                     | 0.16   | 0.21    | 0.33    | 0.46    | 0.031                        |
| LP023         | 0°                    | 30° | 60° | 0.0361   | 0.23                     | 0.28   | 0.36    | 0.58    | 0.81    | 0.039                        |
| LP033         | 0°                    | 30° | 60° | 0.0516   | 0.33                     | 0.40   | 0.52    | 0.83    | 1.17    | 0.047                        |
| LP043         | 0°                    | 30° | 60° | 0.0671   | 0.42                     | 0.51   | 0.66    | 1.05    | 1.48    | 0.059                        |
| LP08          | 0°                    | 30° | 60° | 0.127    | 0.80                     | 0.98   | 1.26    | 2.00    | 2.83    | 0.079                        |
| LP12          | 0°                    | 30° | 60° | 0.196    | 1.24                     | 1.52   | 1.96    | 3.10    | 4.38    | 0.098                        |
| LP20          | 0°                    | 30° | 60° | 0.312    | 1.98                     | 2.42   | 3.13    | 4.95    | 7.00    | 0.118                        |
| LP31          |                       |     | 60° | 0.497    | 3.14                     | 3.85   | 4.96    | 7.85    | 11.1    | 0.157                        |
| LP49          |                       |     | 60° | 0.775    | 4.90                     | 6.00   | 7.75    | 12.3    | 17.3    | 0.197                        |
| LP78          |                       |     | 60° | 1.24     | 7.84                     | 9.60   | 12.4    | 19.6    | 27.7    | 0.236                        |
| LP99          |                       |     | 60° | 1.56     | 9.88                     | 12.1   | 15.6    | 24.7    | 34.9    | 0.276                        |
| LP124         |                       |     | 60° | 1.96     | 12.4                     | 15.2   | 19.6    | 31.0    | 43.9    | 0.315                        |

$$\text{Flow Rate (GPM)} = K\sqrt{\text{PSI}}$$

Standard Materials: 316 Stainless Steel

Spray angle performance varies with pressure. Contact BETE for specific data on critical applications.

SPECIAL PURPOSE

CALL 413-772-0846  
 Call for the name of your nearest BETE representative.