

NFV

Fan Nozzle with Integral Strainer Option

DESIGN FEATURES

- One-piece construction
- No internal parts
- Male connection
- Low nozzle maintenance
- Optional removable strainer for easy cleaning

Connections: Male NPT and BSP

Optional Strainer: 50, 100, 200 mesh

SPRAY CHARACTERISTICS

- High impact
- Uniform distribution

Spray pattern: Flat Fan and Straight Jet

Spray angles: 0°, 15°, 25°, 40°, 50°, 65°, 80°, 95°, 110°

NFV0017: Max spray angle available 80°

NFV0025: Max spray angle available 80°

NFV0033: Max spray angle available 95°

Flow rates: 0.039 to 49.85 L/min

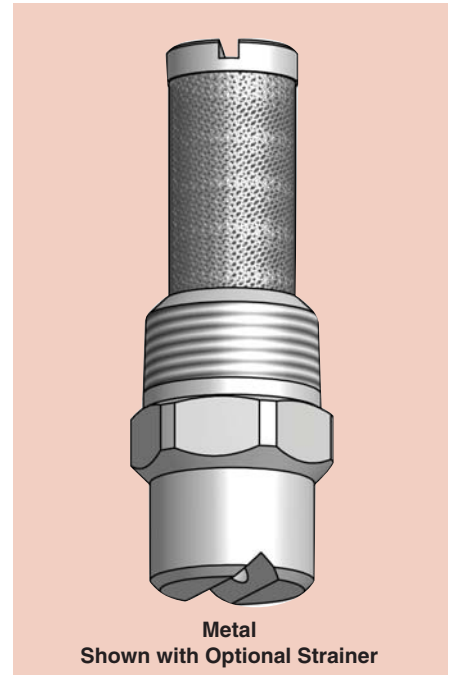

FAN

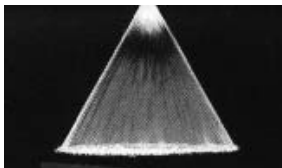

Fan 50°

Call BETE to verify spray angle performance at operating pressures above 30 bar.

NFV Dimensions

Pipe Size	Dimensions (mm)			Wt. (g)
	A	B	C	
1/8	22.4	11.2	37.9	28.4
1/4	26.9	14.2	42.9	42.5

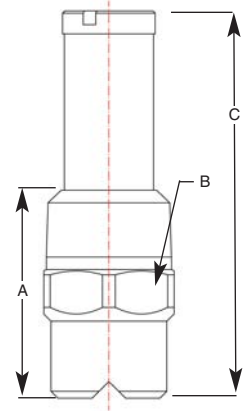

1/8" - 1/4" Metal

To Order: Spray Set-up Number

1/4 NFV 0067 95 -L -B 303

pipe size series nozzle number spray angle optional strainer, also specify mesh size specify material

BSP thread

NFV Flow Rates

Fan and Straight Jet, 0°, 15°, 25°, 40°, 50°, 65°, 80° (all sizes); 95° (NFV0033 and higher); 110° (NFV005 and higher)

Male Pipe Size	Nozzle Number	K Factor	LITERS PER MINUTE @ BAR						Equiv. Orifice Dia. (mm)	Screen Mesh Selection Guide
			1 bar	2 bar	3 bar	5 bar	10 bar	30 bar		
1/8"	NFV0017**	0.039	0.039	0.055	0.067	0.087	0.12	0.21	0.28	200
	NFV0025**	0.057	0.057	0.081	0.099	0.13	0.18	0.31	0.36	200
	NFV0033**	0.075	0.075	0.11	0.13	0.17	0.24	0.41	0.38	200
	NFV005	0.114	0.11	0.16	0.20	0.25	0.36	0.62	0.51	100
	NFV0067	0.153	0.15	0.22	0.26	0.34	0.48	0.84	0.58	100
	or 1/4"	NFV01	0.228	0.23	0.32	0.39	0.51	0.72	1.25	0.66
NFV015		0.342	0.34	0.48	0.59	0.76	1.08	1.87	0.79	100
NFV02		0.456	0.46	0.64	0.79	1.02	1.44	2.50	0.91	100
NFV025		0.569	0.57	0.80	0.99	1.27	1.80	3.12	1.02	50
NFV03		0.684	0.68	0.97	1.18	1.53	2.16	3.75	1.09	50
NFV04		0.912	0.91	1.29	1.58	2.04	2.88	5.00	1.32	50
NFV05		1.139	1.14	1.61	1.97	2.55	3.60	6.24	1.45	50
NFV06		1.367	1.37	1.93	2.37	3.06	4.32	7.48	1.57	50
NFV07		1.598	1.60	2.26	2.77	3.57	5.05	8.75	2.08	50
NFV08		1.823	1.82	2.58	3.16	4.08	5.76	9.98	1.83	50
NFV10		2.279	2.28	3.22	3.95	5.10	7.21	12.48	2.03	50
NFV15		3.418	3.42	4.83	5.92	7.64	10.81	18.72	2.39	50
NFV20		4.550	4.55	6.44	7.88	10.18	14.39	24.92	2.77	50
NFV30		6.826	6.83	9.65	11.82	15.26	21.58	37.39	3.58	50
NFV40		9.101	9.10	12.87	15.76	20.35	28.78	49.85	3.96	50

**NFV0017: Max spray angle available 80°; NFV0025: Max spray angle available 80°; NFV0033: Max spray angle available 95°

Flow Rate (L/min) = $K \sqrt{\text{bar}}$ Standard Materials: Brass and 303 Stainless Steel. Highlighted NFVs available in 316 Stainless Steel.

Spray angle performance varies with pressure. Contact BETE for specific data on critical applications.

www.BETE.com

CALL 413-772-0846
Call for the name of your nearest BETE representative.