

# SS

## Small Droplet Size Dense Fog

### DESIGN FEATURES

- Twelve multiple flat fan patterns
- Solid one-piece construction
- Female connection

### SPRAY CHARACTERISTICS

- Relatively small droplets
- Spray pattern:** Dense full cone  
**Flow rates:** 2.40 to 157 gpm  
**Spray angles:** **SS4.8** thru **SS25** - 35°  
**SS35** thru **SS70** - 45°



Fog

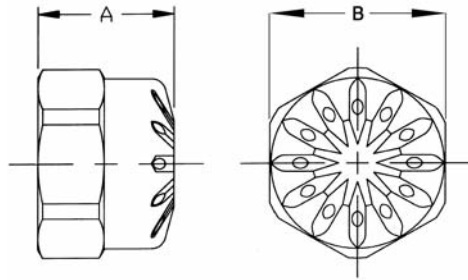

Dimensions are approximate. Check with BETE for critical dimension applications.

### SS Flow Rates and Dimensions

Full Cone Fog, 3/4", 1" and 1-1/4" Pipe Size

Female Pipe Size	Nozzle Number	K Factor	GALLONS PER MINUTE @ PSI										Dimensions (in.)		Wt. (oz.)
			10 PSI	20 PSI	30 PSI	40 PSI	50 PSI	60 PSI	80 PSI	100 PSI	150 PSI	200 PSI	A	B	
3/4	SS4.8	0.759	2.40	3.39	4.16	<b>4.80</b>	5.37	5.88	6.79	7.59	9.3	10.7	1.0	1.25	3
	SS9	1.42	4.50	6.36	7.79	<b>9.00</b>	10.1	11.0	12.7	14.2	17.4	20.1			
	SS12	1.90	6.00	8.49	10.4	<b>12.0</b>	13.4	14.7	17.0	19.0	23.2	26.8			
	SS18	2.85	9.00	12.7	15.6	<b>18.0</b>	20.1	22.0	25.5	28.5	34.9	40.2			
1	SS25	3.95	12.5	17.7	21.7	<b>25.0</b>	28.0	30.6	35.4	39.5	48.4	55.9	1.16	1.50	5
	SS35	5.53	17.5	24.7	30.3	<b>35.0</b>	39.1	42.9	49.5	55.3	67.8	78.3			
1 1/4	SS50	7.91	25.0	35.4	43.3	<b>50.0</b>	55.9	61.2	70.7	79.1	96.8	112	1.22	1.88	8
	SS70	11.1	35.0	49.5	60.6	<b>70.0</b>	78.3	85.7	99.0	111	136	157			

$$\text{Flow Rate (GPM)} = K \sqrt{\text{PSI}}$$

Standard Materials: Brass, 303 and 316 Stainless Steel.

Spray angle performance varies with pressure. Contact BETE for specific data on critical applications.

MISTING

CALL 413-772-0846  
Call for the name of your nearest BETE representative.