

ScrubMate™



ScrubMate™ Rotating Washing Nozzles

DESIGN FEATURES

- Compact design fits through small openings. O.D.: SM50 - 49mm, SM75 - 72mm, SM30 - 35mm
- Superior cleaning at low pressures and low flow rates for greater economy
- Self cleaning
- Patented mist reducing head
- No ball bearings to corrode

SPRAY CHARACTERISTICS

- High impact scrubbing action
 - Slow rotation speed provides better cleaning
 - Wide coverage
- Flow rates:** 66 to 283 l/min



ScrubMate™ SM50

ScrubMate™ SM30

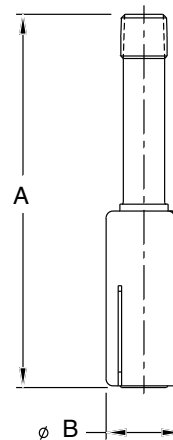
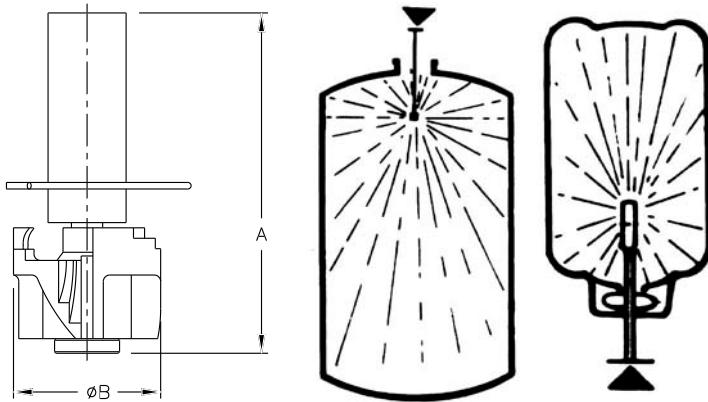

ScrubMate™ SM30

ScrubMate™ Coverage Chart

When spraying at 3 bar

	Nozzle Number	Scrubbing Diameter (mm)	Rinsing Diameter (mm)
Pipe Size:			
1/2"	SM30	1500	2000
Tube Size:			
1"	SM50	2100	4200
1 1/2"	SM75	2700	5400

Dimensions are approximate. Check with BETE for critical dimension applications.

ScrubMate™ Flow Rates and Dimensions

ScrubMate™ 360°, 1" and 1 1/2" Pipe Sizes, Sanitary Connection

	Nozzle No.	K Factor	LITERS PER MINUTE @ BAR					Approximate Free Passage Dia. (mm)	Dim. (mm)		Wt. (kg)
			1 bar	2 bar	3 bar	3.5 bar	4 bar		A	B	
Pipe Size:											
1/2"	SM30	72.95	73	103	126	136	146	1.397	175	34	0.27
Tube Size:											
1"	SM50	66.09	66	93	114	124	132	2.794	124	49	0.19
1 1/2"	SM75	141.3	141	200	245	264	283	4.699	165	72	0.44

$$\text{Flow Rate (l/min)} = K \sqrt{\text{bar}}$$

Standard Materials: Body/Shaft - 316 Stainless Steel, Rotor - Acetal-CoPolymer or PTFE.

SPECIAL PURPOSE

TO ORDER: specify pipe size, connection type, nozzle number, spray angle, and material.